

of

located in Government Lot 1 in the Northeast 1/4 of Section 28, Town 2 North, Range 16 East, Town of Delavan, Walworth County, Wisconsin.

Legal Description

Lot 34 of Makovsky's Subdivision, together with a parcel of land located in the Northeast 1/4 of Section 28, Town 2 North, Range 16 East, Town of Delavan, Walworth County, Wisconsin, described as follows, to-wit: A portion of Makovsky's Subdivision known as "walk" lying East of and adjoining said Lot 34, and described follows: Beginning at the Southeast corner of said Lot 34; thence North along the Eastly extension of the North line of said Lot 34; 18.00 feet to the West line of Lot 9 of Cedar Point; thence South along the West line of said Lot 9; 357.6 feet more or less to the shore of Delavan Lake; thence West along the shore of Delavan Lake 18.0 feet to the Southeast corner of said Lot 34; thence North along the East line of said Lot 34; 357.1 feet to the place of beginning.

Surveyed for: **Keefe Real Estate, Inc.**
416 Bauer Parkway
Delavan, Wisconsin. 53115

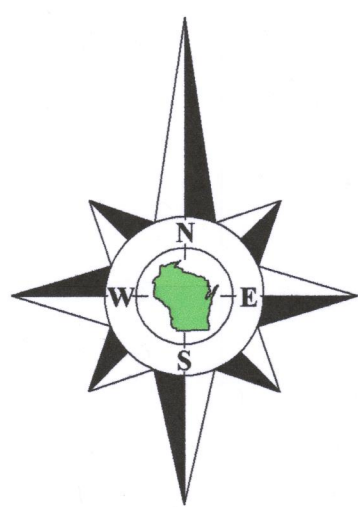

Bearings referenced to the West line of the Northeast 1/4 of Section 28-2-16, recorded as N0°59'43"W in the Wisconsin State Plane Coordinate System, South Zone, (NAD-27).

Underground Utilities

See Note 4

Underground Utilities

---S--- Sanitary Sewer Line

---G--- Gas Line

---T--- Telephone Line

North 1/4 Corner
Section 28-2-16
N. 225,921.05
E. 2,374,287.09

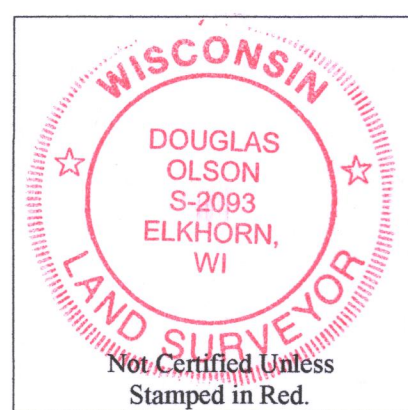

Notes:

- 1) This Plat of Survey is not certified unless signed and sealed in red ink.
- 2) This survey is subject to Wisconsin lien laws. This Plat of Survey is the notice of intent to file lien. Lien waiver required.
- 3) The Survey Date shown on this Plat of Survey is the completion date of the field work.
- 4) The approximate location of underground utilities are shown as flagged by diggers hotline.

N86°31'22"E 551.86'

Meander Corner
Section 28-2-16
N. 224,136.42
E. 2,374,318.09

Copyright© 2017 by Olson Land Surveying, LLC.

All rights reserved. No part of this survey plat may be reproduced or transmitted in any form by any means - graphic, electronic, or mechanical, including photocopying, tracing, or information storage and retrieval systems - without permission in writing from Douglas G. Olson, Olson Land Surveying, LLC.

I hereby certify that I have surveyed the above described property in compliance with Chapter A-E 7 of the Wisconsin Administrative Code and that the map hereon is correct to the best of my professional knowledge and belief and shows the size and location of the property, its exterior boundaries, the location and dimensions of all visible structures thereon, boundary fences, apparent easements and roadways and visible encroachments, if any.

This survey is made for the exclusive use of the present owners of the property, and also those who purchase, mortgage or guarantee title thereto, within one year from the date hereof.

Douglas G. Olson
Wisconsin Professional Land Surveyor - 2093



Sheet 1 of 1 Sheets

Drawing Name:

Job Reference Number

2017.057

Legend of Symbols & Abbreviations

- Found County Section Corner
 ⊗ Found Iron Pipe
 ⊗ Found Iron Rod
 ⊗ Set Iron Pipe, 1" dia.
 () Recorded Information
 □ Utility Pole
 □ Utility Pedestal
 □ Concrete Cover
 □ Septic Vent
 □ Asphalt Surface
 □ Concrete Surface
 □ Gravel Surface
- 8'  Coniferous Tree
 & Diameter
 10' M  Deciduous Tree &
 Diameter & Species
 O Oak
 M Maple
 C Crab Apple

N North
S South
E East
W West
In Bearings
" Degrees
" Minutes
" Seconds
In Distances
" Feet
" Inches
No. Number
NW. Northwest
NE. Northeast
Dia. Diameter



45 South Wisconsin Street | P.O. Box 322
Elkhorn, Wisconsin. 53121
Telephone: (262) 723-3434
Facsimile: (262) 723-8044
Email: doug@olsonsurveying.com
Website: www.olsonsurveying.com

Scale in Feet
1" = 20'

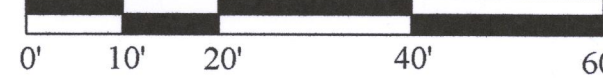

Survey date: June 23, 2017.

Revisions: No. 1 - Topo, Utilities, etc.

FMA8-7A 216-5424

2017.057